

**SPECTRUM COURT**

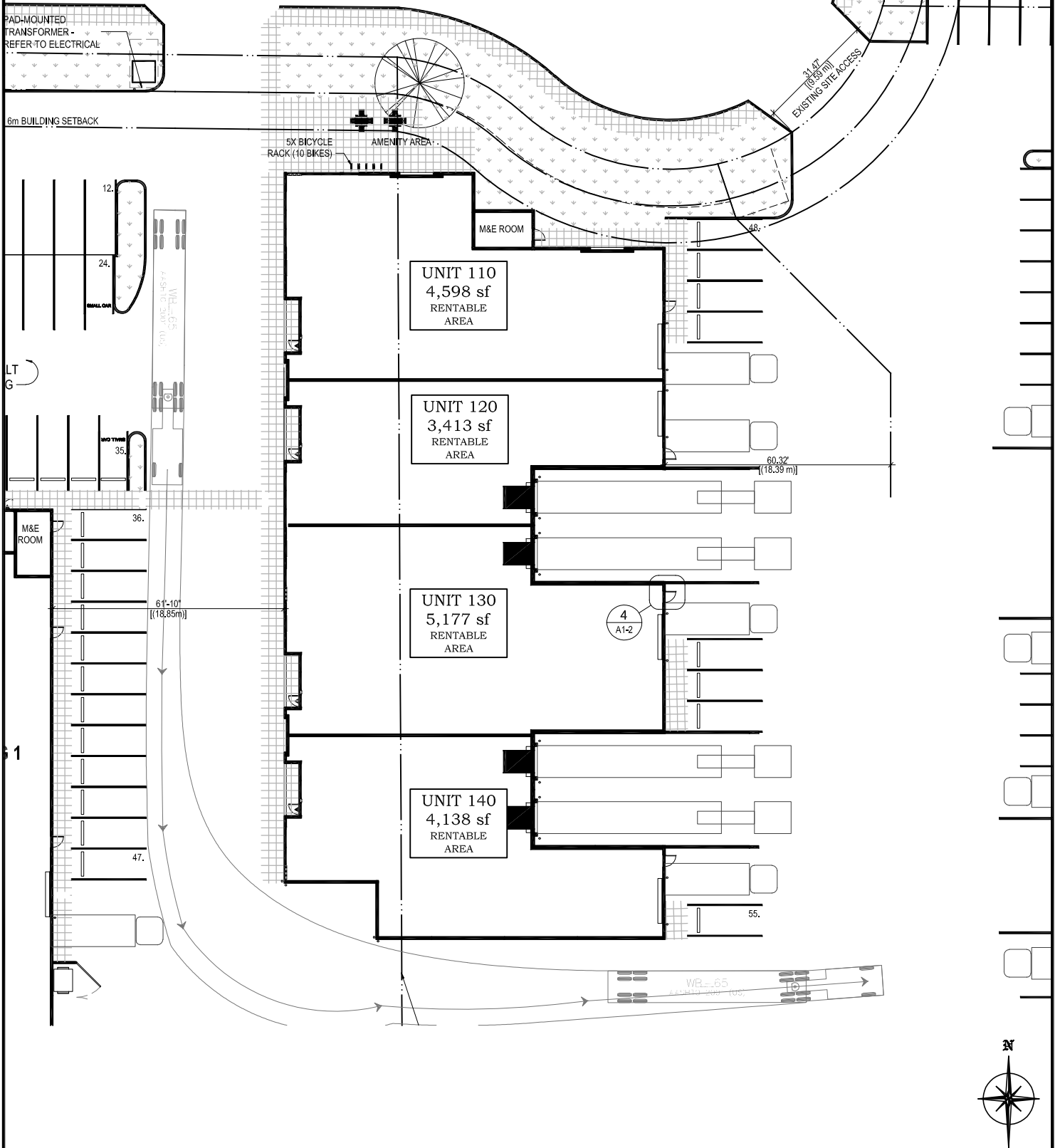

**ARGUS**  
PROPERTIES LTD.

Suite 300 - 1060 Manhattan Drive  
Kelowna, British Columbia V1Y 9X9  
T:(250) 763-6789 F:(250) 763-6799

PROJECT:  
1545 INNOVATION DR.  
KELOWNA BC

DRAWING:  
SITE PLAN

DATE:  
MAR. 12/20

INIT.  
KM