

West Kelowna Business Park

1445 Stevens Road, West Kelowna, BC



Features

- Up-to +/- 23,225 sq.ft. of newly constructed industrial space in West Kelowna.
- Bays starting at +/- 3,995 sq. ft.
- High exposure to Stevens Road.
- Easy access to Highway 97 via Ross Road and Westlake Road.
- Grade and dock level doors.
- 26' clear ceiling heights & mezzanine potential.
- Home to Crown Packaging, Air Liquide, Bliss Bakery, Alpine Aerotech, Andritz, and Accent Custom Furniture.

Location

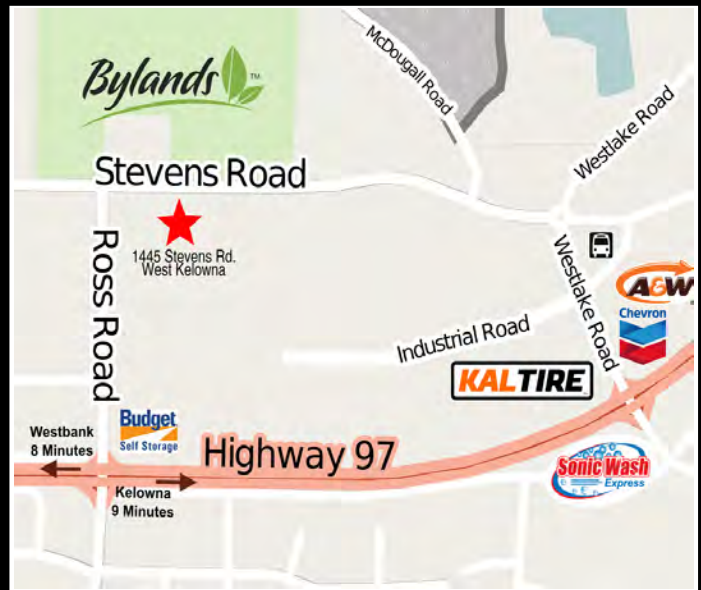

ARGUS[®]
PROPERTIES LTD.

250-763-6789
www.ArgusProperties.ca
Follow us on **LinkedIn**

West Kelowna Business Park

1445 Stevens Road, West Kelowna, BC

Property Description

Available Spaces:

Units #110-#150 Up-to 23,225 sq.ft.

Rent: Call to Inquire

Utilities: Metered I-1 (Light

Zoning: Industrial)

Availability: Q4 2019

West Kelowna Business Park



Contact Information

Rob Smith

Director of Leasing

RSmith@ArgusProperties.ca

Site Plan

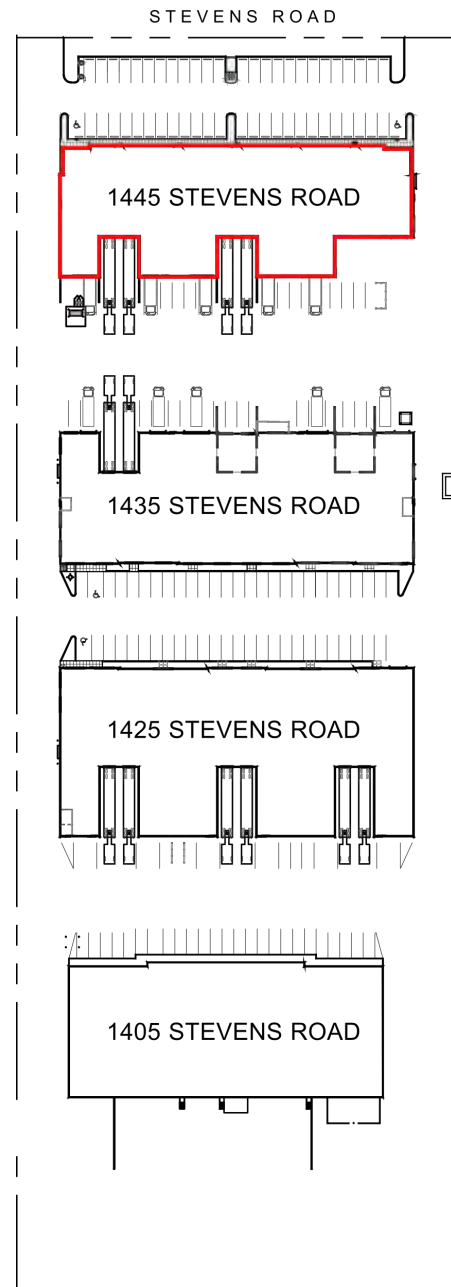

ARGUS[®]
PROPERTIES LTD.

250-763-6789
www.ArgusProperties.ca

Follow us on [LinkedIn](#)

West Kelowna Business Park

1445 Stevens Road, West Kelowna, BC

Building Plan

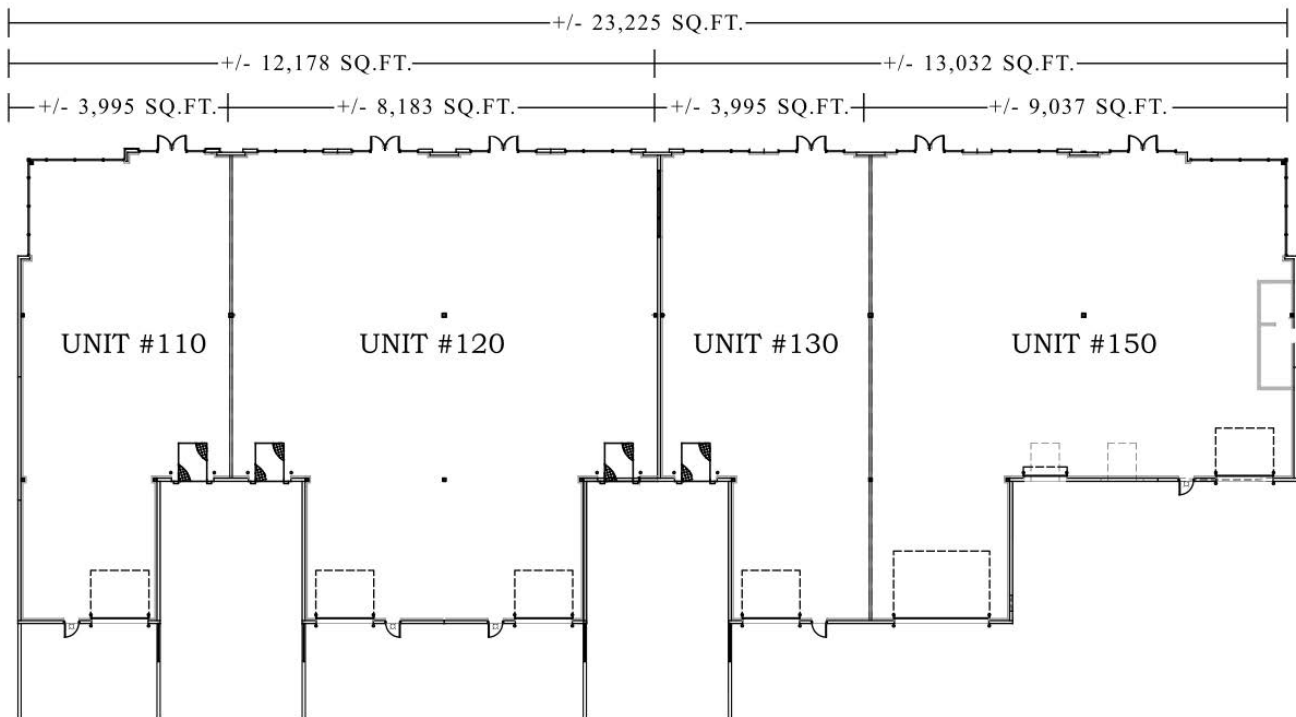

ARGUS[®]
PROPERTIES LTD.

250-763-6789
www.ArgusProperties.ca
Follow us on [LinkedIn](#)

West Kelowna Business Park

1445 Stevens Road, West Kelowna, BC

Photos

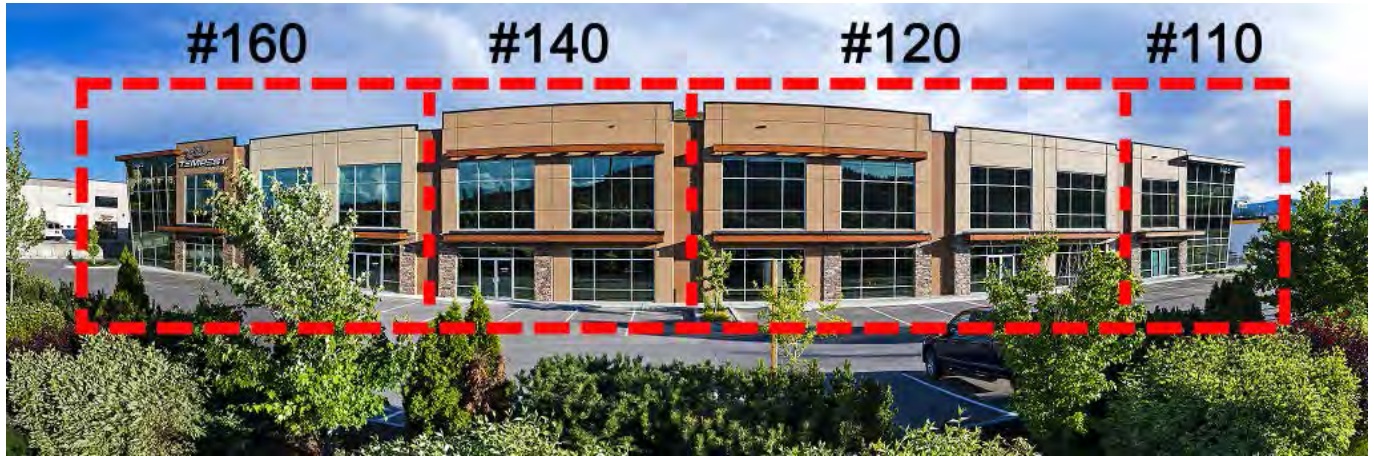

ARGUS[®]
PROPERTIES LTD.

250-763-6789
www.ArgusProperties.ca
Follow us on [LinkedIn](#)