

Springfield Retail Centre

#118 – 2189 Springfield Road, Kelowna, BC



Features

- Rare opportunity for a retail space right across the street from Orchard Park Mall.
- Springfield Road exposure with 27' 9" Frontage.
- Average Annual Daily Traffic along Springfield Road is 25, 735 (City of Kelowna).
- Approximately 2,113 +/- sq. ft. of Retail Space with ample parking.
- Pylon Signage Opportunity.
- Other tenants in the Centre include:
Bamboo Chopsticks Restaurant,
Shell Gas Station, Mac's Convenience Store,
Popeye's Supplements, and Money Mart.

Location



250-763-6789
www.ArgusProperties.ca

Follow us on [LinkedIn](#)

Springfield Retail Centre

#118 – 2189 Springfield Road, Kelowna, BC

Property Description

Square Footage:	2,113 +/- sq. ft. Rentable
Net Rent:	Market
Est. Op. Cost:	\$8.21 (2017)
Zoning:	C4 Urban Centre Commercial
Availability:	Immediate
Signage:	Pylon Signage Available

Main Plate

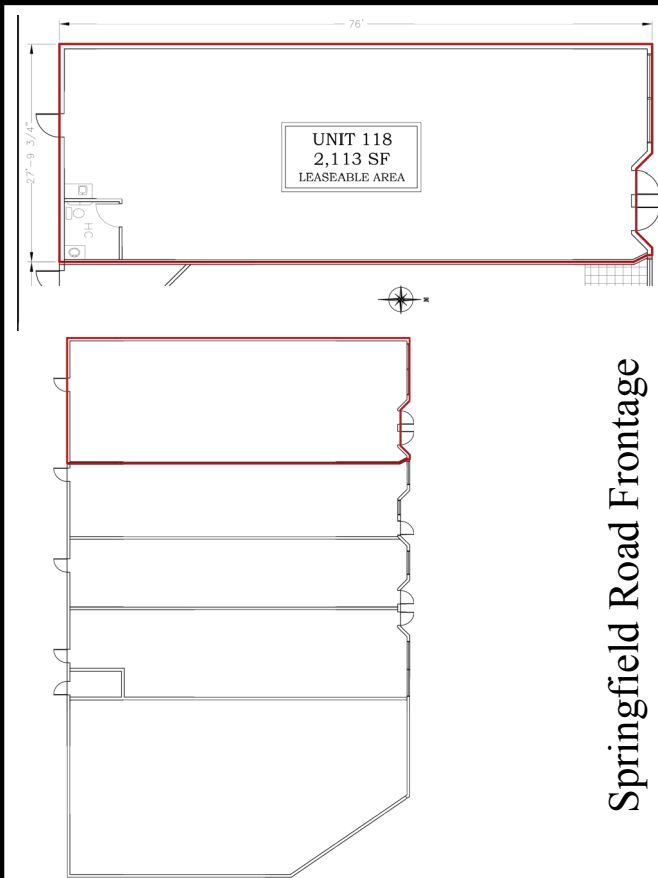

Photos



Contact Information

Kristopher Mazey

Retail Leasing

KMazey@ArgusProperties.ca



ARGUS
PROPERTIES LTD.

250-763-6789
www.ArgusProperties.ca

Follow us on [Linked in](#)